



Combination Type LL/LR Conduit Bodies

1/2" thru 2" Trade Sizes



Cat Numbers: LLR-41 thru LLR-46

UPC Numbers: 78174703441 thru 78174703446

Description: Type LL/LR Combination EMT/Rigid Conduit Body with Cover and Gasket Type Conduit Body
Application: For use with both EMT and rigid conduit, thus eliminating the need to stock separate units for each application. Units have a threaded interior for rigid applications and set screws for use with EMT. The design allows access to the interior of a conduit system for inspection, pulling and maintenance.

Trade Size: 1/2" thru 2"

Material: Aluminum

Certifications & Codes

UL Standard: UL514A

cULus File: E11077

Dimensions (LLR-41 Shown)

Dimension A: 1 3/8"

Dimension B: 2"

Dimension C: 2"

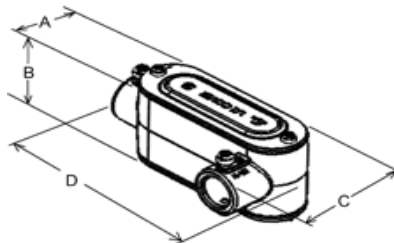

Get Your

FREE SAMPLE

[Click Here](#)

Features

- Threaded for use with rigid or IMC conduit
- Set screws for use with EMT Conduit
- **UL Listed Raintight** when used with rigid conduit
- Preassembled with cover and gasket - no need to carry additional components
- Reduces SKUs - eliminates the need to stock separate units for each application
- Ideal for service trucks
- Excellent for use in tight or difficult locations